

**BIMETAL DIAL THERMOMETERS STEM HORIZONTAL
INDUSTRIAL VERSION, ACCURACY: CLASS 1,6 OR 1,0**

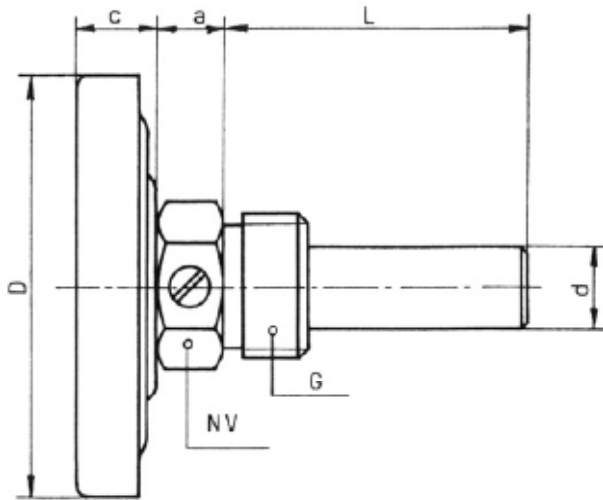

DIMENSIONAL DATA IN MM.

TYPE NO Accuracy 1,6	TYPE NO Accuracy 1,0	D	c	a	NV	G	d	L=STD.IMMERSION TUBE
330	3030	34	9	10,5	17	¼" RG	8	45, 50, 60, 80, 100 120, 160, 200, 300
331	3050	50	12	10,5	22	½" RG	12	
332	3063	63	13	10,5	22	½" RG	12	
333	3080	80	13	10,5	22	½" RG	12	
334	3100	100	15	10,5	22	½" RG	12	
335	3160	160	17	10,5	22	½" RG	12	

CASE AND BEZEL : Nickel plated steel / varnished
WINDOW : Instrument Glass
DIAL : White with black markings. 270 ° defl
STEM : ø 9 mm. brass with adjusting screw.
POCKET : ½" BSP brass ø 12 mm.

RANGES °C	GRADUATION	RANGES °C	GRADUATION	RANGES °C	GRADUATION
-40 + 40	: 1	0 - 50	: 1	0 - 200	: 2
-30 + 50	: 1	0 - 60	: 1	0 - 250	: 5
-20 + 60	: 1	0 - 80	: 1	0 - 300	: 5
-15 + 45	: 1	0 - 100	: 2	0 - 400	: 5
-10 + 60	: 1	0 - 120	: 2	0 - 500	: 5
0 - 40	: 1	0 - 160	: 2	0 - 600	: 10

OPTIONS FOR BIMETAL THERMOMETERS:

- Surface mounting flange
- Panel mounting flange
- Alarm contact
- One-way reset maximum pointer
- Glycerine filling
- Scale range °F or °C+°F
- Other pipe threads
- Red mark on dial